



USER GUIDE - Kiosk Printer Troubleshooting Guide

Kiosk Printer Troubleshooting Guide



Kiosk Printer Information

- ❖ This guide assumes that you already have some knowledge of the Kiosk device and have the keys to access the Printer.
- ❖ This guide will take you through ensuring the correct settings are configured on the Printer and then paper is aligned correctly.
- ❖ All Kiosks use Non-Perforated Sticker Rolls.



Kiosk Printer Troubleshooting Guide



Inside the Printer

Lift the Printer head by pressing the button on the bottom right at the front of the printer.

- ❖ The Citizen CL-S400DTZ printer can be opened up by pressing the Printer Head Release button on the front of the printer.
- ❖ This will open up the printer so we can investigate and confirm the settings inside the printer and the paper roll.



Kiosk Printer Troubleshooting Guide



Align the Paper

Follow instructions to align the sticker roll in the printer

- ❖ Once opened, we need to ensure the plastic paper roll aligner is on the right of the sticker roll
- ❖ Ensure the Stickers on the roll are face up, it is fed under the paper guides.

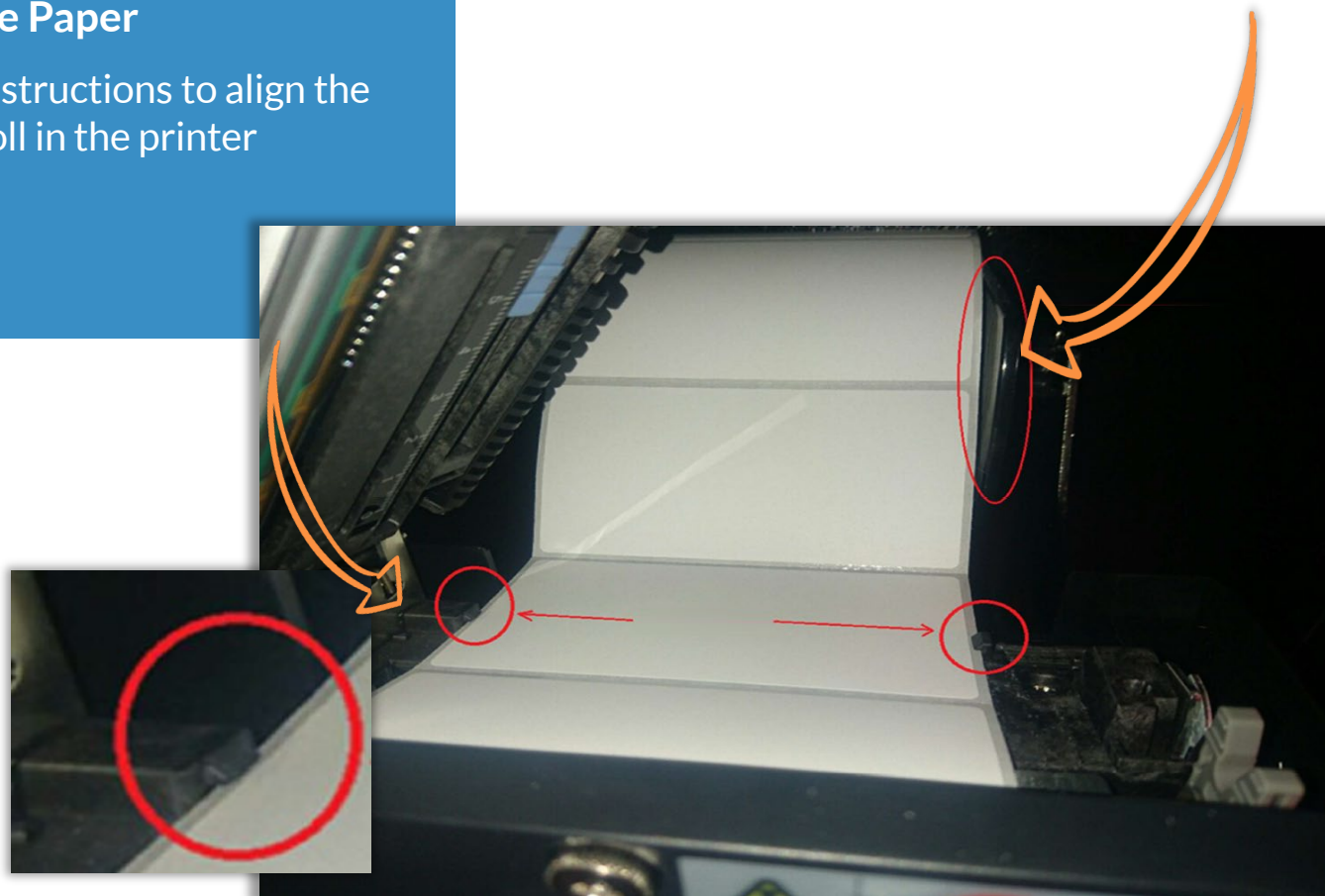

Kiosk Printer Troubleshooting Guide



Check Gap Sensors

Two gap sensors need to be checked

- ❖ 2 x Paper gap sensors are inside the printer.
- ❖ Ensure the bottom sensor is aligned to have the arrow notch point onto number 5

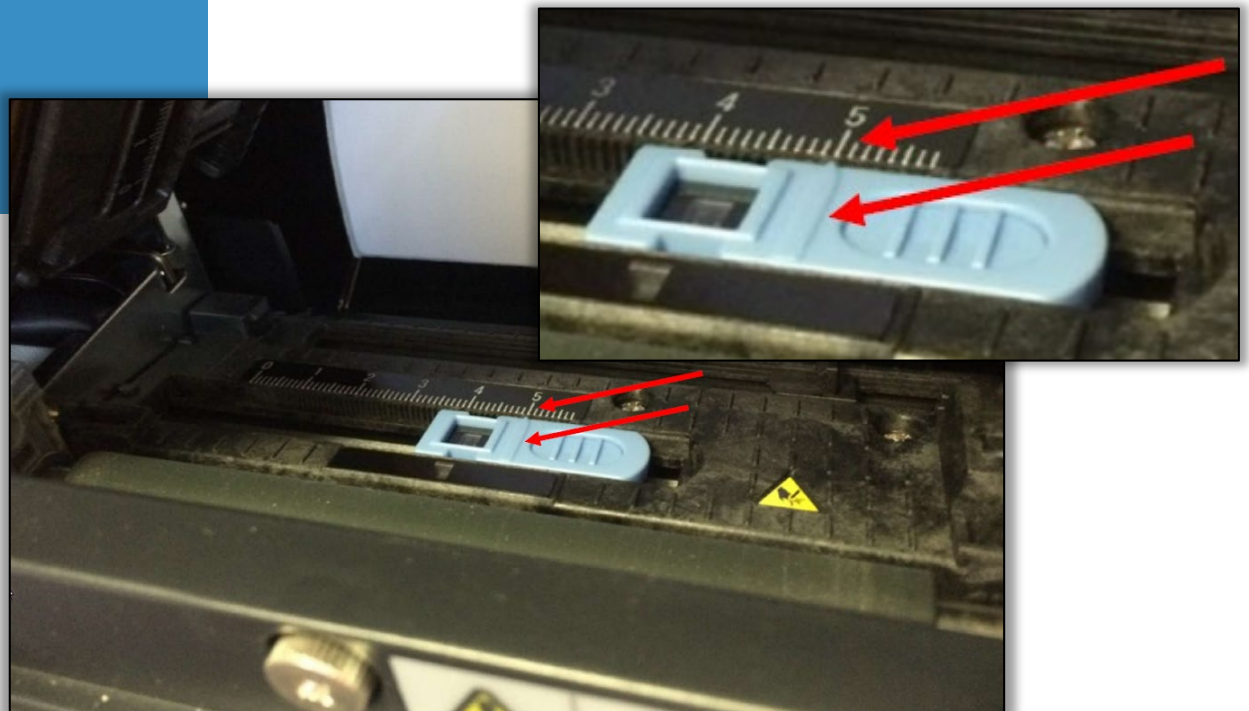

Kiosk Printer Troubleshooting Guide



Check Gap Sensors

Two gap sensors need to be checked

- ❖ 2 x Paper gap sensors are inside the printer.
- ❖ Ensure the top sensor, situated on the print head, is aligned to have the arrow notch point onto number 5

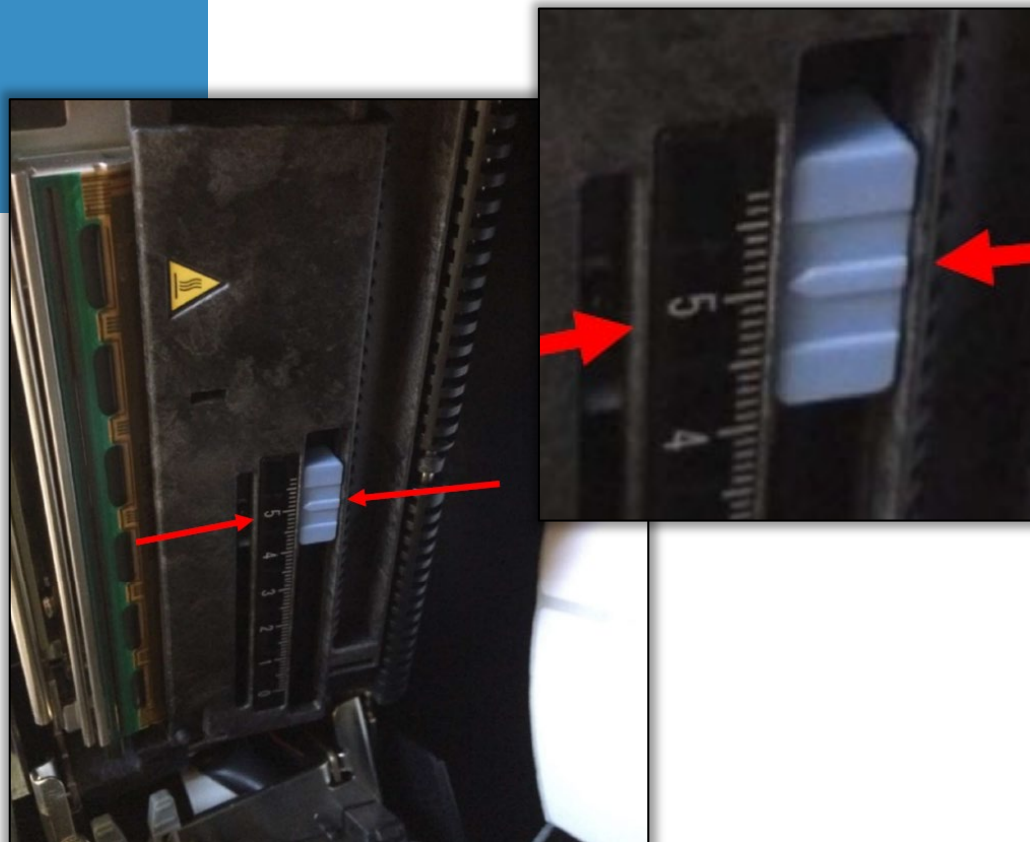

Kiosk Printer Troubleshooting Guide



Test Feed

You can now test the feed function

- ❖ Once all checks have taken place, you can do a test feed.
- ❖ Pressing the FEED button once will feed a sticker through and cut it.
- ❖ If this is successful, then printer should be fine to resume normally operation.





FOR ANY QUESTIONS OR ASSISTANCE PLEASE CALL

1300 131 194

OR EMAIL support@onsitetrackeasy.com.au